

HIGH PRECISION GRAPHITE MACHINING CENTER

# **VX 6500G**

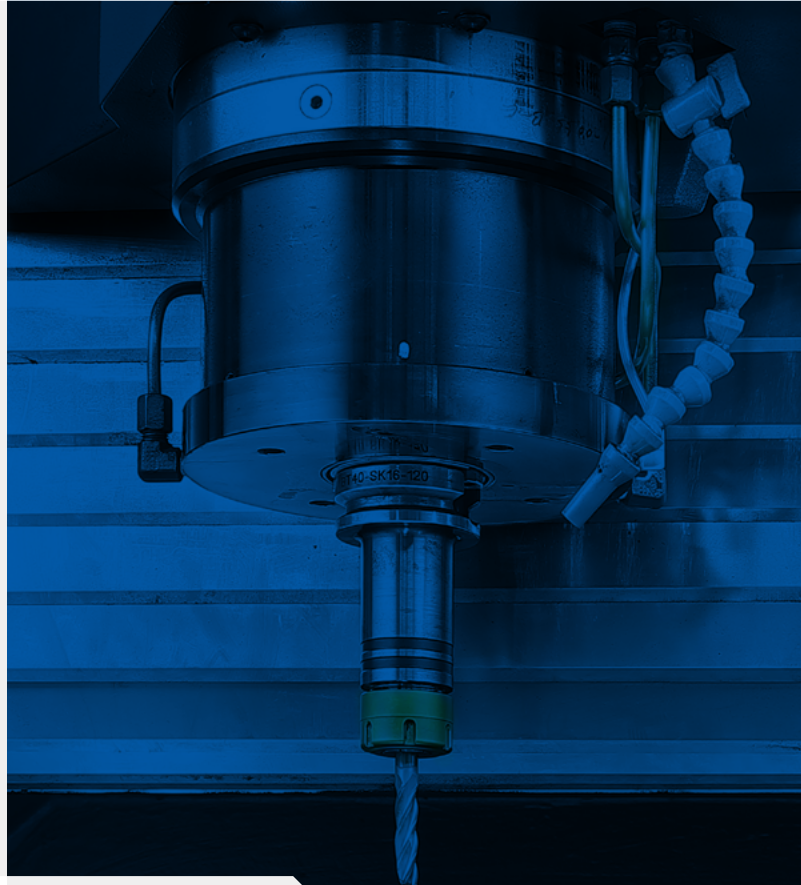

# BASIC STRUCTURE

VX6500G has the Bridge type structure for high-performance, high-accuracy machining.

## Travel distance

### X axis

**1050** mm (41.3 inch)

### Y axis

**650** mm (25.6 inch)

### Z axis

**550** mm (21.7 inch)

## Rapid traverse rate

### X axis

**30** m/min (1181.1 ipm)

### Y axis

**30** m/min (1181.1 ipm)

### Z axis

**30** m/min (1181.1 ipm)

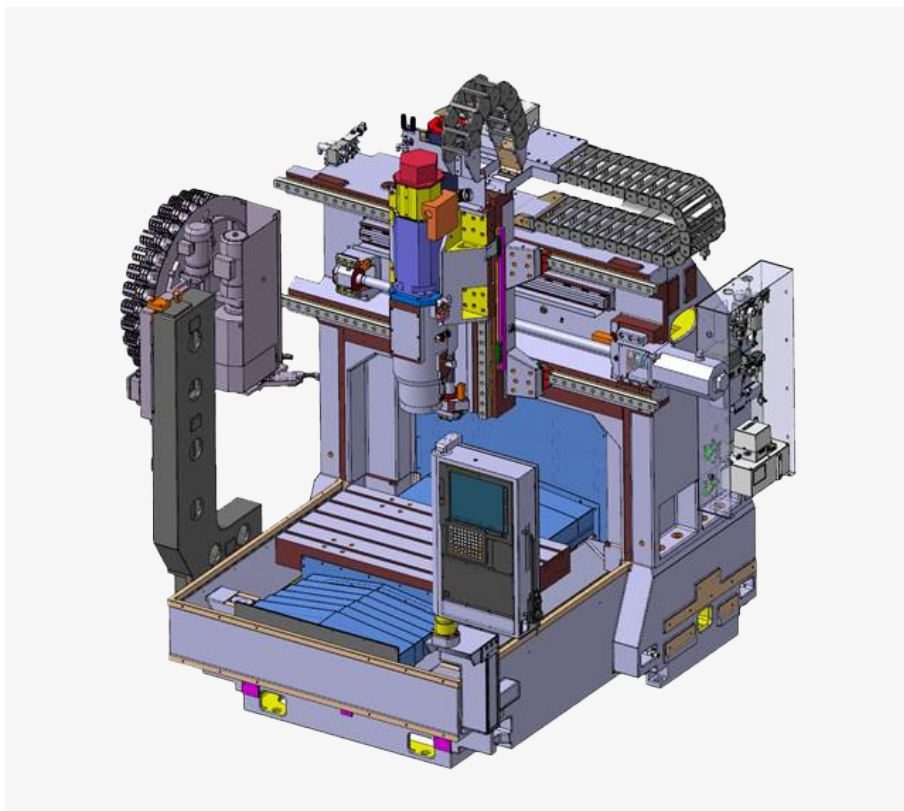

# SPINDLE

The new spindle provides low noise and high precision performance.

## Max. spindle speed

**12000** r/min

20000, 30000, 40000 r/min OPTION

## Max. Spindle power

**18.5/11** kW (24.8/14.8 Hp)

22/11, 18.5/13, 5.5/3.7 kW OPTION  
(29.5/14.8, 24.8/17.4, 7.4/5.0 Hp)

## Max. spindle torque

**117.8** N·m (86.9 ft-lbs)

60, 5.9, 3.5 N·m OPTION  
(44.3, 4.4, 2.6 ft-lbs)

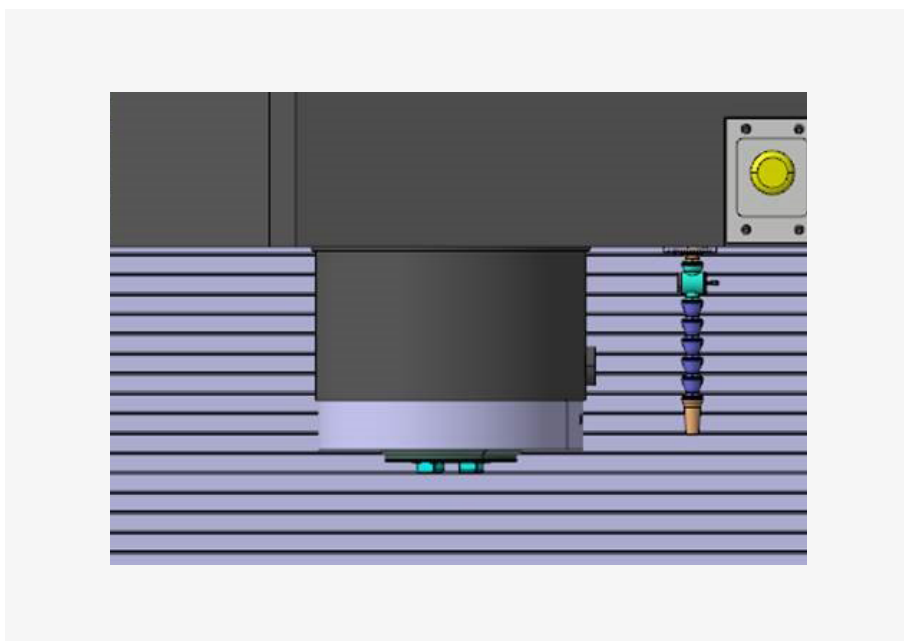

# GRAPHITE PACKAGE

Various protection package from graphite dust which can effect to reliability and accuracy of axis and spindle.

Protective device applied for outstanding linear axis accuracy of feed drive system.

## 1. Ball screw cover

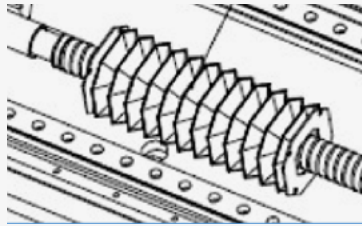

VX 6500G is capable of processing various high hardness/ high heat resistance ceramic materials such as Si (silicon), SiC (silicon carbide), aluminum oxide, and Quartz.

## 2. LM guide double wiper

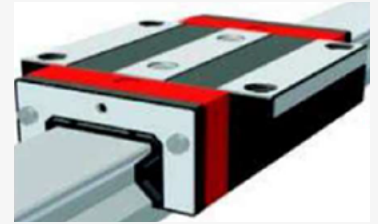

## 3. Grease lubrication



## 4. Spindle lubrication air-oil suction unit

(Only built-in spindle (20/30/40K) **OPTION**)

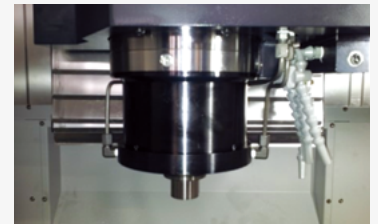

## 5. Graphite dust collector

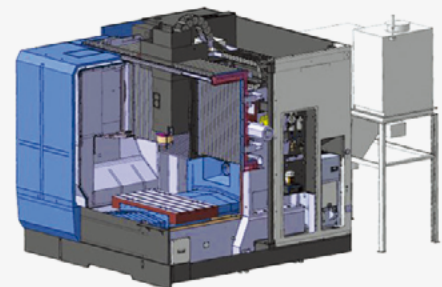

Realizes high-quality, high-precision machining with smoothing thermal displacement compensation of the spindle and structure.

### Compensation of static displacement of spindle

Compensates in tool position caused by expansion of the spindle shaft at high speed.

### Structure thermal displacement compensation

Compensates irregular deflection or expansion of the structure due to ambient temperature using a multiple temperature sensors.

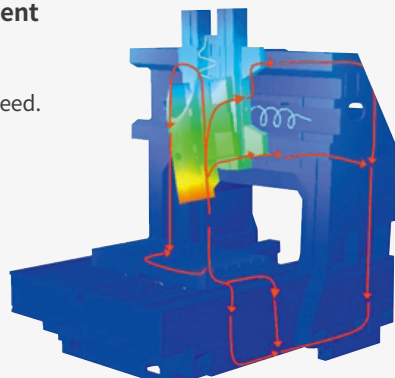

**Head Office**

19F, 10, Tongil-ro, Jung-gu, Seoul,  
Republic of Korea, 04527

Tel: +82-2-6972-0370  
Fax: +82-2-6972-0400

**DN Solutions America**

360 E State PKWY,  
Schaumburg, IL. 60173,  
United states

Tel: +1-315-265-7500

**DN Solutions Europe**

Emdener Strasse 24, D-41540  
Dormagen, Germany

Tel: +49-2133-5067-100  
Fax: +49-2133-5067-111

**DN Solutions India**

No.82, Jakkuar Village  
Yelahanka Hobil,  
Bangalore-560064

Tel: +91-80-2205-6900  
E-mail: [india@dncompany.com](mailto:india@dncompany.com)

**DN Solutions China**

Room 101,201,301,  
Building 39 Xinzhuan Highway  
No.258 Songjiang District  
China Shanghai (201612)

Tel: +86 21-5445-1155  
Fax: +86 21-6405-1472

**DN Solutions Vietnam**

M.O.R.E building 2F, 40A-40B Ut  
Tich Street, 04 Ward 04,  
District Tan Binh District,  
Ho Chi Minh City, Vietnam

Tel: +84 28-7304-0163

**DN Solutions Mexico**

Avenida Parque Bicentenario  
#100 Nave M65L3-6,  
Fraccionamiento San Isidro  
Business Park,  
Santa Rosa Jauregui,  
Querétaro, México

E-mail: [efrain.figueroa@dncompany.com](mailto:efrain.figueroa@dncompany.com)

**Sales inquiry**

[sales@dncompany.com](mailto:sales@dncompany.com)